

# 12" Shallow base

## B-12S

### Applications

The shallow base is designed to mount a 12" inset light into a taxiway or runway pavement location.

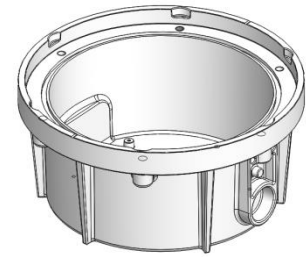

### Compliance with standards

- FAA: AC 150/5345-46
- FAA: AC 150/5345-42
- IEC TS 61827

### Mechanical

- Static Load: > 25 t
- Net weight: 5kg
- Gross Weight: 5.5kg

### Features

- Corrosion proof cast aluminum alloy
- Black electrophoretic coating
- Optional side entry and bottom entry
- Optional one or two side entries for the cable
- M10 stainless steel bolts and lock washers
- Equipped with 1×O-ring gasket for watertight
- Earth point provided

### Outline drawing (mm)

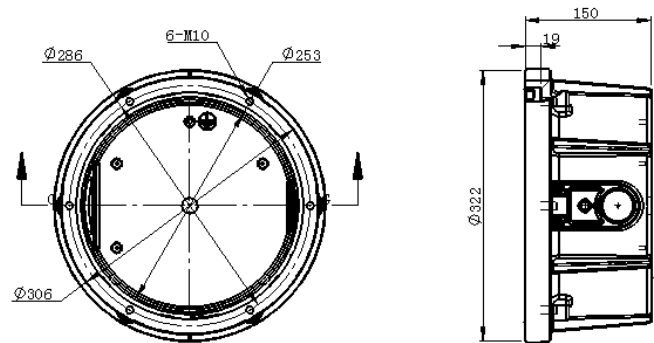

### Ordering information



B-12S-E

1 input, side and bottom entry interchangeable, equipped with a cable gland and a thread plug.

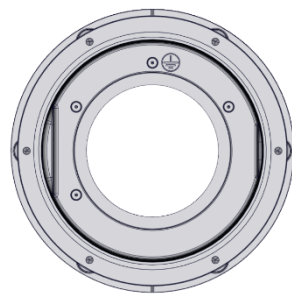

B-12S-G

Bottom entry,  $\varnothing 150$  mm hole or as requirement.

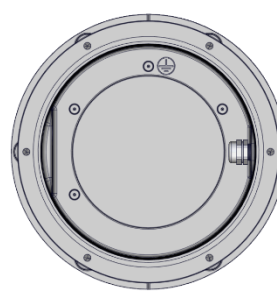

B-12S-H

1 input, side entry, equipped with 1 cable gland.

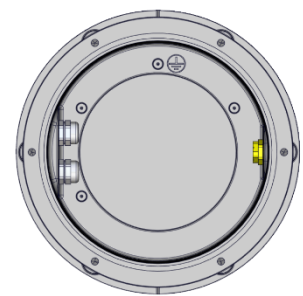

B-12S-F

2 inputs, Side entry, equipped with 2 cable glands and a thread plug.

\* Two side entries can be changed by exchange one cable gland and thread plug.

# Accessories of 12" Shallow base

## 8"-12" Adapter Ring

### ■ AR-0812-C



Manufacturing Method: Forged  
Material: Corrosion proof aluminum alloy  
Finish: Anodic oxidation

#### DIMENSIONS (mm)

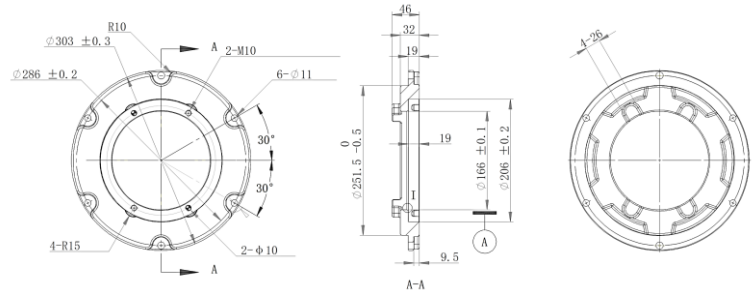

## Cover Plate

### ■ CP-12B



Manufacturing Method: Machine made  
Material: Corrosion proof aluminum alloy  
Finish: Anodic oxidation

#### DIMENSIONS (mm)

